

CREDENZA SILENZIO - LIMITED EDITION

“Intarsia tre” Collection design Robert Hromec

There are many ways to make meaningful and sophisticated piece of furniture. To be different is to be unique. The technique should be only a means to an end - that of creative expression at the highest level. Thanks to the ancient art of wood inlay (Intarsia) the outlines of faces create 3D effect of light and shadow and transforms the Silenzio credenza into an unique piece of art. Among the most appealing aspects of Intarsia is the directness and swiftness of making an image of incredible power and aesthetic strength. With the use of different dyed veneers I made a particular colored impression, and so affected the way we perceive the piece.

You can listen to silence and learn from it. Silence is better than unmeaning words. It has a quality and a dimension all its own. Silence is a source of great strength and a journey of discovery at the same time. Our life is an endless journey. It consists of constant ups and downs. We are happiest when we are fully engaged in work we enjoy on the journey toward the goal we've established for ourselves. It gives meaning to our time. Be different. Be unique. Be silenzio.



BEDIF
FEREN
TBEUN
IQUE

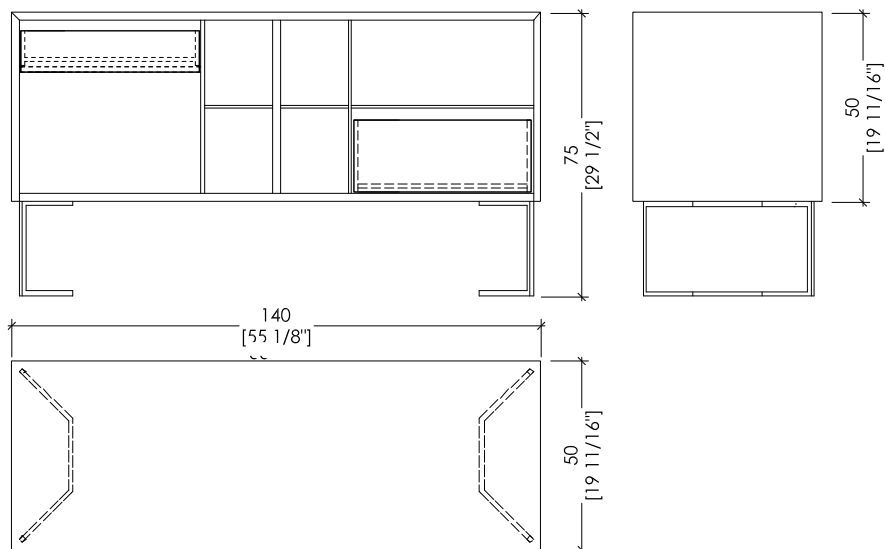

BEDIF
FEREN
TBEUN
IQUE